

7-3-1026

### BASEMENT FLOOR PLAN

FINISHED AREA = 1036 SQ. FT. (96.2 M<sup>2</sup>)

9' CEILING HEIGHT

WIDTH - 42'-0" (12.8 M)

DEPTH - 63'-0" (19.2 M)

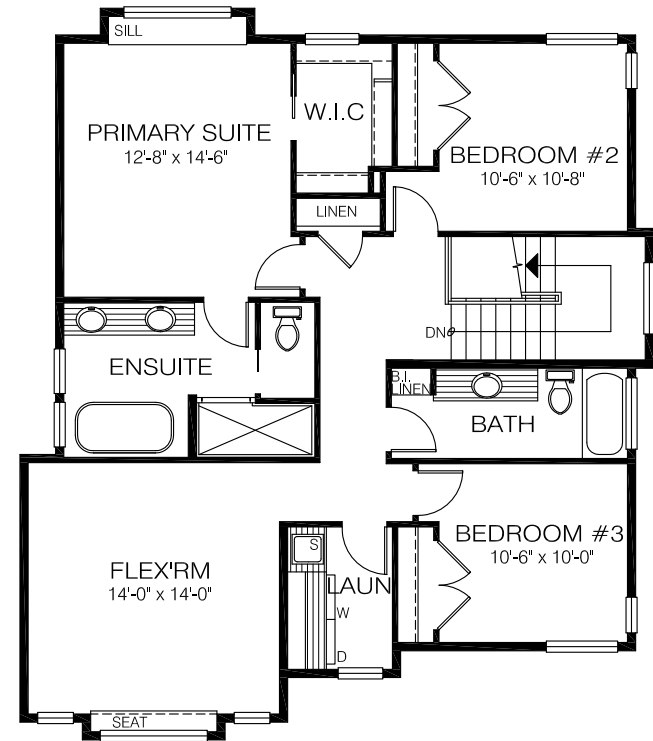

### SECOND FLOOR PLAN

FINISHED AREA = 1141 SQ. FT. (106.0 M<sup>2</sup>)